

Incadrare in zona

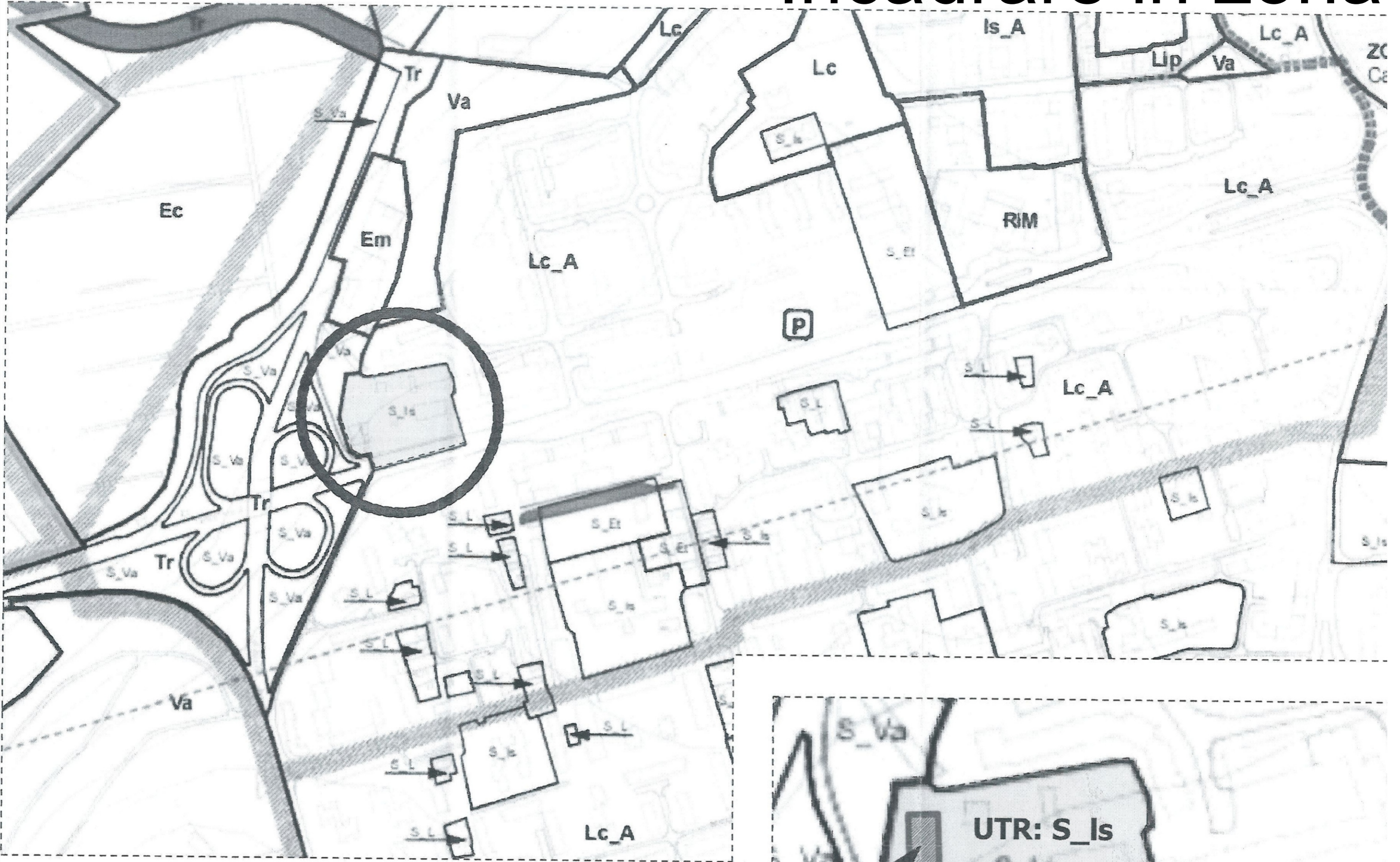

PLAN DE INCADRARE IN PUG CLUJ-NAPOCA

JUDEȚUL CLUJ - PRIMĂRIA MUNICIPIULUI CLUJ-NAPOCA
ANEXĂ LA CERTIFICATUL DE URBANISM
Nr. 286 din 21 JAN 2020
Arhitect șef 

IMOBIL PROPUȘ
CENTRU TRANSFER TEHNOLOGIC

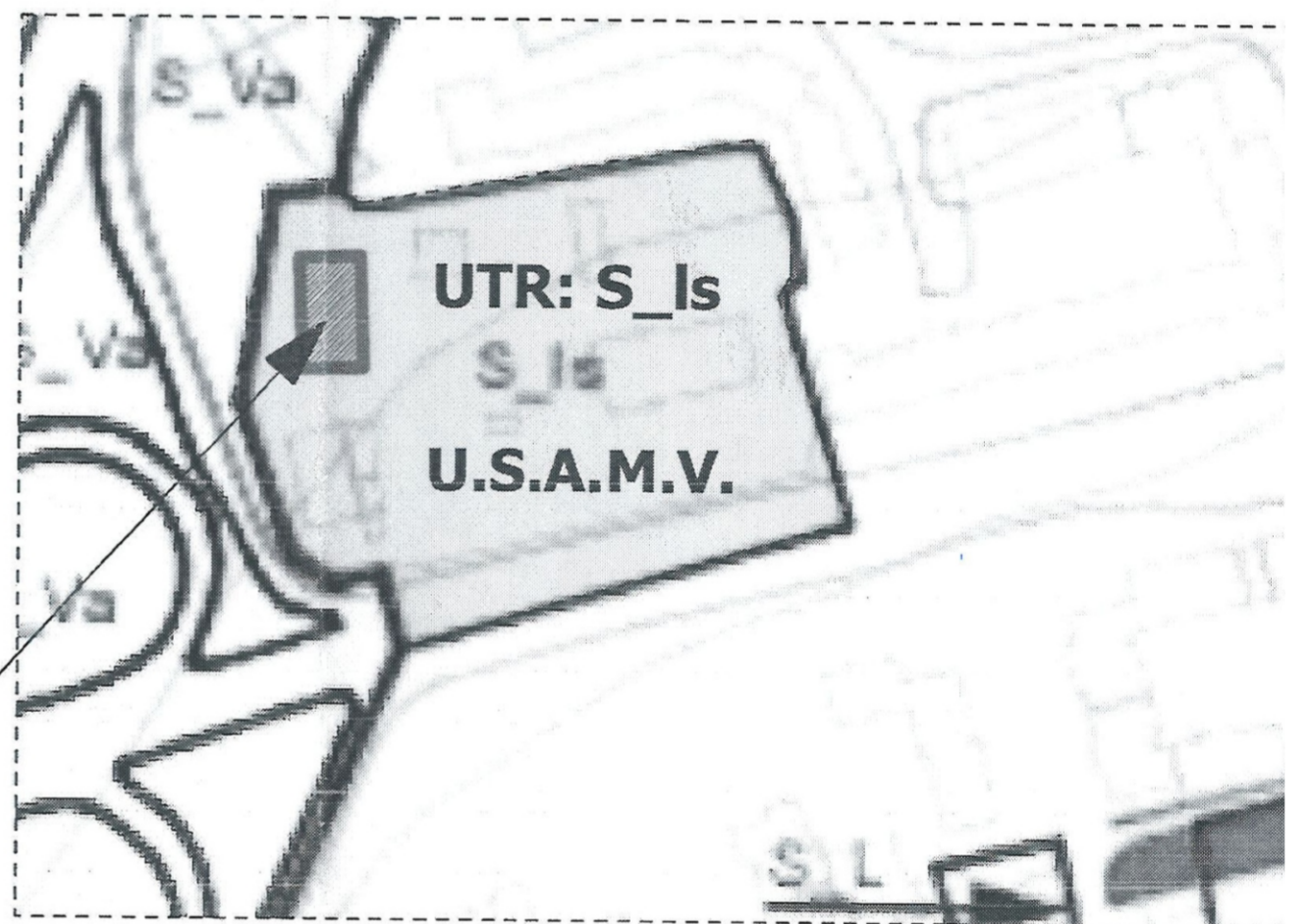

Incadrare in zona

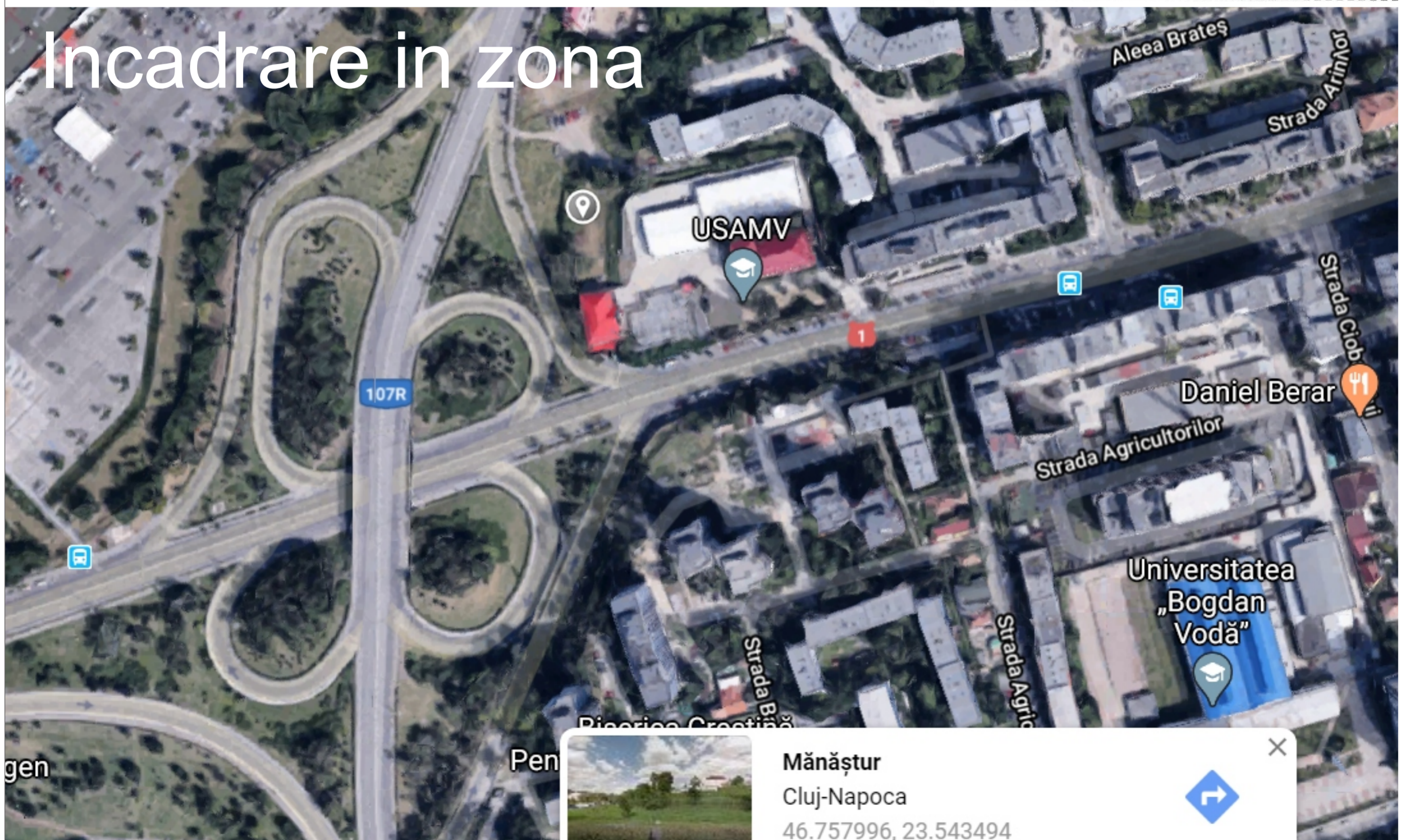

PLAN TOPOGRAFIC
(intravilan)
SCARA 1:1000





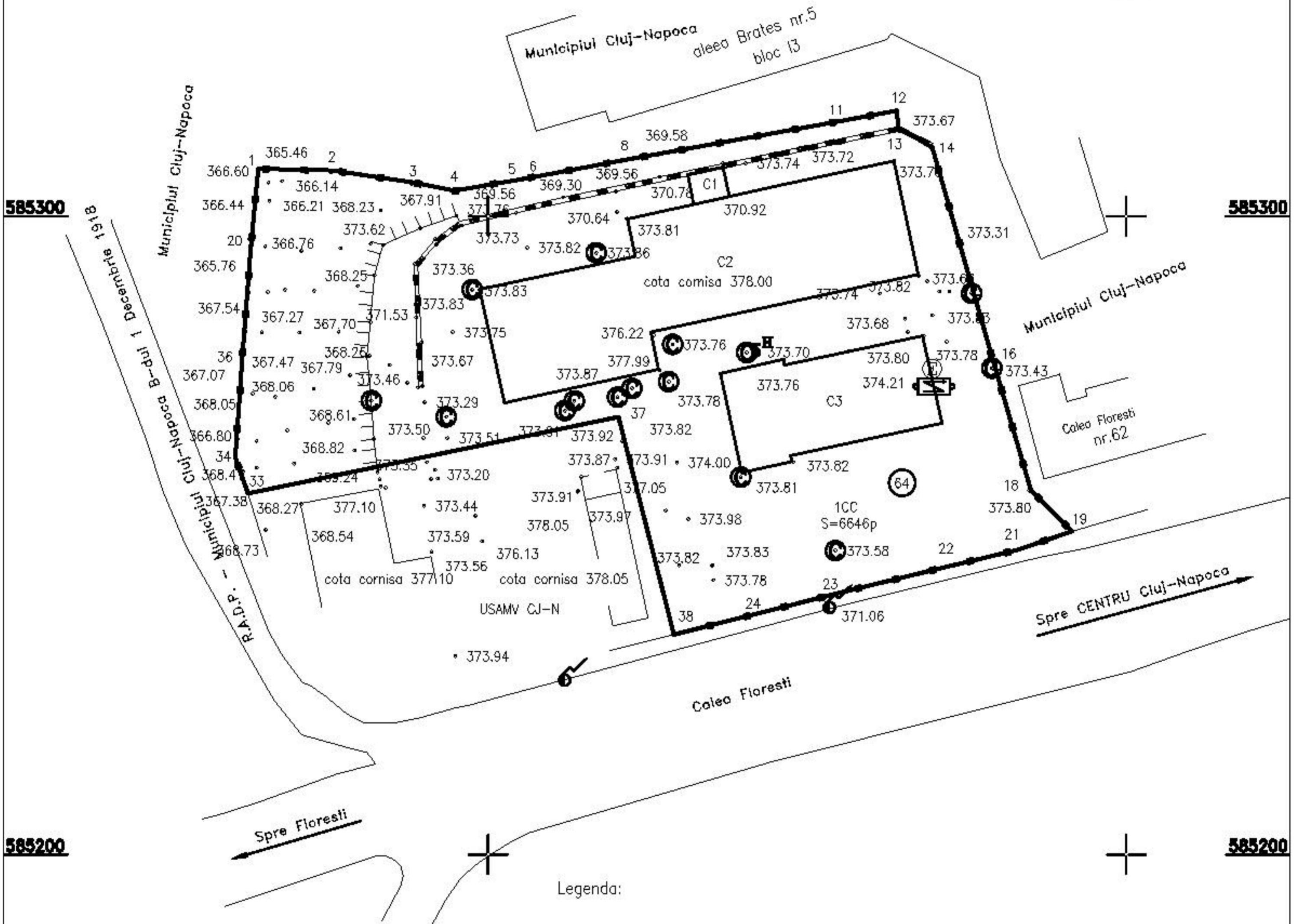

Beneficiar:
Universitatea de Stiinte Agricole si Medicina Veterinara
Calea Manastur, nr. 3-5, Cluj-Napoca, jud. Cluj

Sistem de Proiectie : Stereografic 1970
Sistem de Cote: Marea Neagra 1975
Cota la cornisa cladirilor: 378.00 m; 377.10 m : 378.10 m

CF nr. 326585, Cad 326585
Categorica de Folosinta : CC
S= 6646 mp
Amplasament: Calea Floresti, nr. 64, Cluj-Napoca

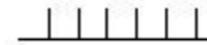

Legenda:

-  Panou Electric
-  Camin Vizitare Canalizare
-  Contor Electric
-  Stalp de beton
-  Aerisitor Gaz
-  Zid Sprijin
-  Gard metal
-  Taluz

Mihai Konradi
Digitally signed by Mihai Konradi
Date: 2020.06.22
11:12:39 +03'00'

BURA ALEXANDRU
Digitally signed by BURA ALEXANDRU
Date: 2020.06.03
12:51:15 +03'00'

Executant:
Ing. ALEXANDRU BURA
Aut. categ. B, seria RO-CJ-F, nr. 0200/2018

Parcela (3)

Nr. Pct.	Coordonate pct.de contur X [m]	Y [m]	Lungimi laturi D(i,i+1)
38	585234.451	388929.106	12.849
24	585237.650	388941.550	9.586
23	585240.130	388950.810	30.065
22	585247.410	388979.980	2.034
21	585247.830	388981.970	3.578
20	585248.880	388985.390	6.314
19	585250.620	388991.460	9.054
18	585256.850	388984.890	8.379
17	585264.850	388982.400	11.725
16	585276.080	388979.030	34.180
15	585309.010	388969.870	2.997
14	585311.260	388967.890	2.736
13	585311.810	388965.210	4.730
12	585316.380	388963.990	15.043
11	585313.740	388949.180	14.392
10	585311.110	388935.030	1.017
9	585310.990	388934.020	12.930
8	585308.670	388921.300	16.644
7	585305.720	388904.920	13.564
6	585303.320	388891.570	6.020
5	585303.270	388885.550	4.923
4	585307.020	388882.360	6.613
3	585306.600	388875.760	4.542
2	585306.150	388871.240	2.720
1	585305.920	388868.530	35.832
36	585270.490	388863.180	6.313
35	585264.260	388862.160	3.293
34	585260.970	388862.020	4.426
33	585256.560	388862.400	59.263
37	585268.527	388920.442	35.160

S (3) = 6434.70mp P = 380.922m

Mihai Konradi Digitally signed by Mihai Konradi Date: 2020.06.22 11:12:39 +03'00'

BURA ALEXANDRU Digitally signed by BURA ALEXANDRU Date: 2020.06.03 12:51:15 +03'00'

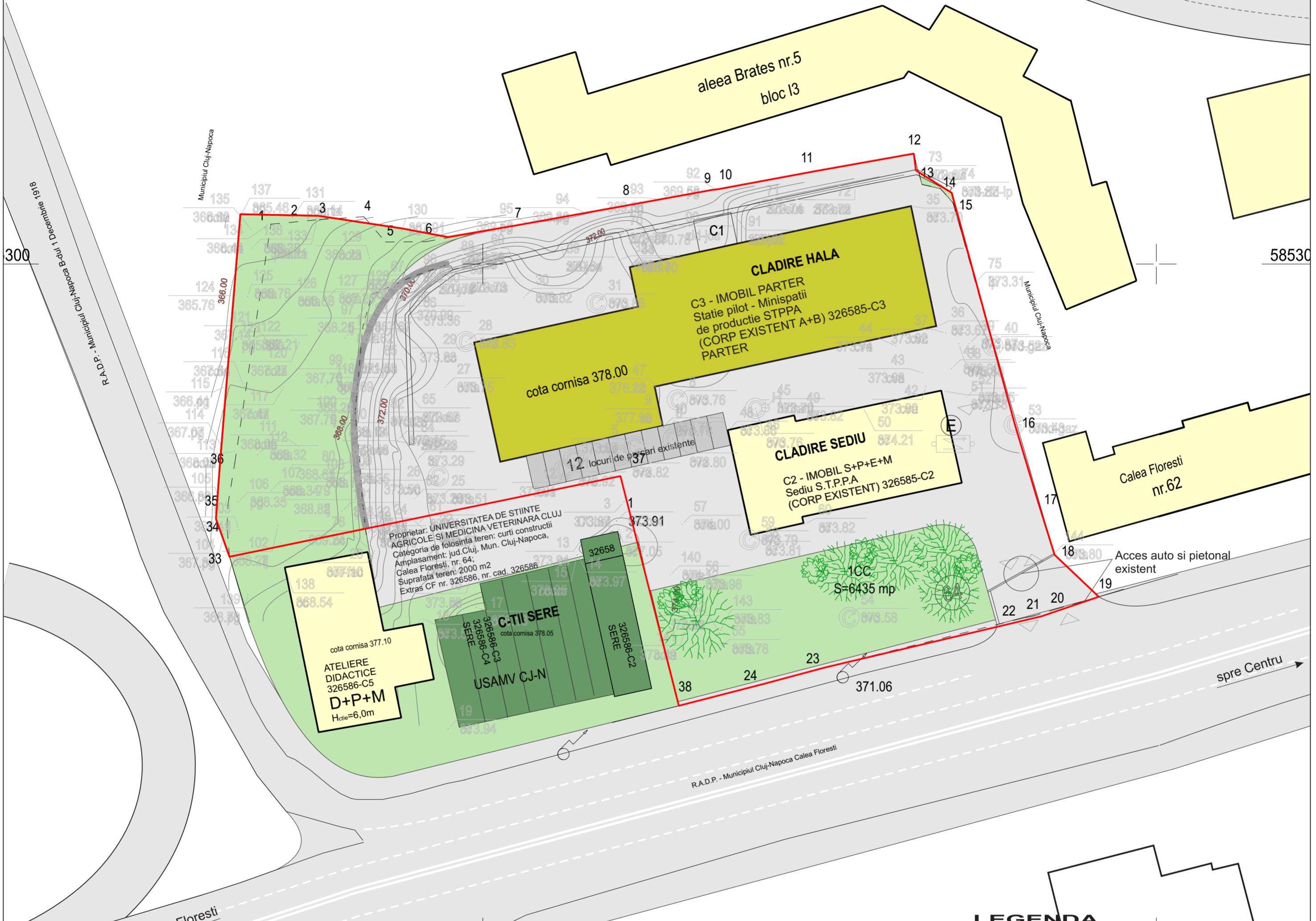
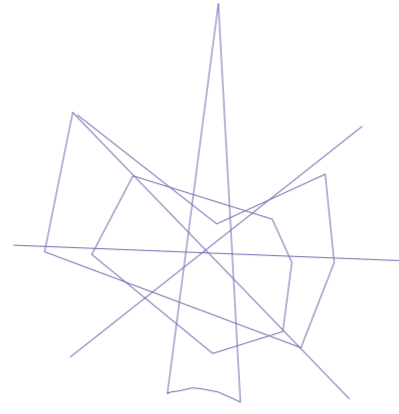

Indicatori parcelari:

BILANT TERITORIAL EXISTENT

NR.	Zona functionala	SUPRAFATA (MP)	% DIN TOTAL
1	Imobile	1724.00	25.94
2	cai de comunicatie -Alei acces	2350.00	35.35
3	Zona verde	2570.00	38.66
4	pct.gosp.com.	2	0.05
5			
6	Total teren studiat	6646.00	100

REGIM TEHNIC
Suprafata teren conf. CF = 6646 mp
Suprafata construita existenta = 1724 m2

P.O.T. existent = 25.94 %
C.U.T.existent = 0.47

Proprietar: UNIVERSITATEA DE STIINTE AGRICOLE SI MEDICINA VETERINARA CLUJ
Categoriza de folosinta teren: curti constructii
Amplasament: jud.Cluj, Mun. Cluj-Napoca, str. Calea Floresti, nr. 64;
Suprafata teren: 6646 m2
Extras CF nr. 326585, nr. cad. 326585

LEGENDA

- LIMITA ZONEI STUDIATE
- LIMITE PROPRIETATI
- ALINIAMENT
- TEREN STUDIAT PROPRIETATE
- CONSTRUCTII EXISTENTE
- CAI DE COMUNICATIE**
- CALE DE COMUNICARE AUTO SI PIETONALA
- NUMAR CASUTA POSTALA
- ACCES PIETONAL IN INCINTA
- ZONE VERZI**
- ZONE VERZI PROPUSE
- ECHIPARE TEHNICO-EDILITARA PROPUSE**
- LINIE ELECTRICE AERIANE DE JOASA TENSIUNE
- RETEA ALIMENTARA CU APA
- RETEA GAZE NATURALE
- RETEA TELEFONIE
- RETEA CANALIZARE
- ZONA GOSPODARIE COMUNALA

Proiectant general
BIROU DE PROIECTARE



S.C. SML CONSTRUCT S.R.L.
CUI: RO 19050468, J12/3172/2006
Sediul: Gilau, str. Braniste nr.113, jud. Cluj
office@smlconstruct.ro, 0740.092.110

ing. SALANTĂ MARIUS LUCIAN

Situatia existenta

SPESIFICATIE	NUME	SEMNETURA	SCARA	Denumirea proiectului: PUD CONSTRUIRE IMOBIL D+P+SE CU DESTINATIA CENTRU DE TRANSFER TEHNOLOGIC CTT-BIOTECH	NR. PR. 14/2020
SEF PROIECT	ARH. UNGUR CRISTIANA		1-500	Amplasament: calea Manastur nr.3-5, jud. Cluj Beneficiar: UNIVERSITATEA DE STIINTE AGRICOLE SI MEDICINA VETERINARA CLUJ	PUD
PROIECTAT	ARH. UNGUR CRISTIANA				UP1
DESENAT	ARH. UNGUR CRISTIANA				

Parcela (1)

Nr. Pct.	Coordonate pct.de contur		Lungimi latimi D(i,i+1)
	X [m]	Y [m]	
38	585234.451	388929.106	14.392
24	585237.958	388943.064	12.469
23	585241.001	388955.156	17.578
22	585245.168	388972.233	10.978
21	585247.715	388982.911	9.029
19	585250.620	388991.460	9.088
18	585257.045	388985.033	21.006
16	585277.206	388979.134	34.856
14	585310.725	388969.574	6.139
13	585313.882	388964.309	2.614
12	585316.477	388963.998	9.053
11	585314.838	388955.095	34.147
8	585308.789	388921.488	15.135
6	585306.015	388906.609	2.926
5	585305.509	388903.727	9.156
4	585303.971	388894.701	6.693
3	585305.260	388888.133	12.676
2	585307.142	388875.597	11.589
1	585307.392	388864.011	12.597
20	585294.853	388862.806	17.640
36	585277.263	388861.482	15.105
34	585262.198	388860.387	5.987
33	585256.560	388862.400	59.263
37	585268.527	388920.442	35.160

S(1)=6646mp P=385.274m

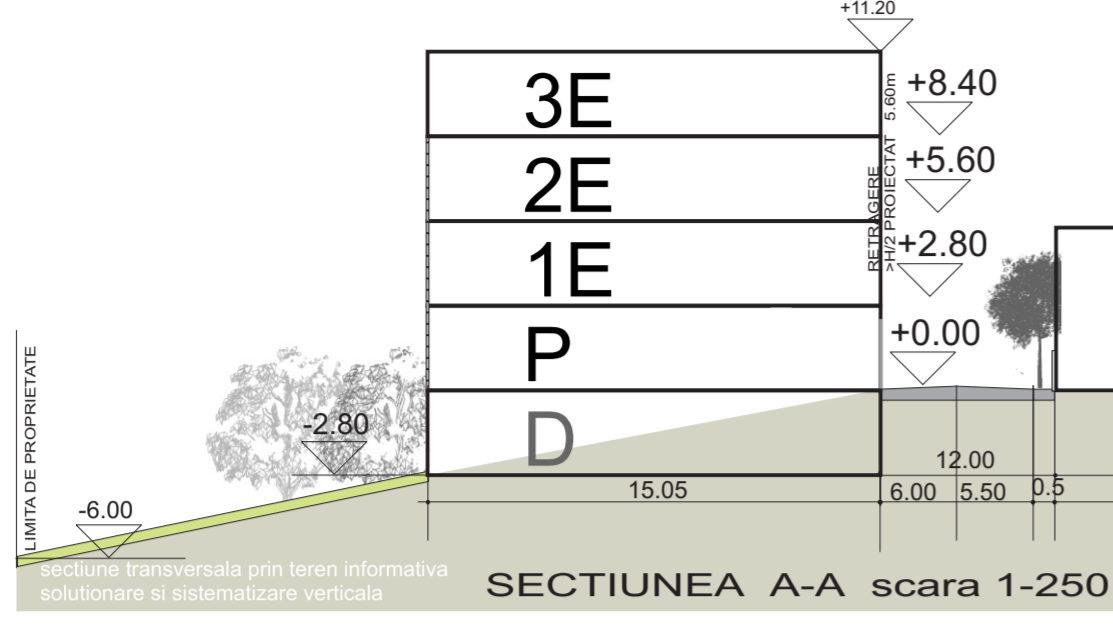

BILANT TERITORIAL

NR.	Zona functionala	SUPRAFATA (MP)	% DIN TOTAL	SUPRAFATA (MP)	% DIN TOTAL
1	Imobile	1724.00	25.94	2136.50	32.14
2	cai de comunicatie -Alei acces	2350.00	35.35	2998.41	45.11
3	Zona verde	2570.00	38.66	1509.09	22.70
4	pct.gosp.com.	2	0.05	2	0.05
5					
6	Total teren studiat	6646.00	100	6646.00	100

BURA ALEXANDRU
Digitally signed by BURA ALEXANDRU
Date: 2020.06.03 12:51:15 +03'00'

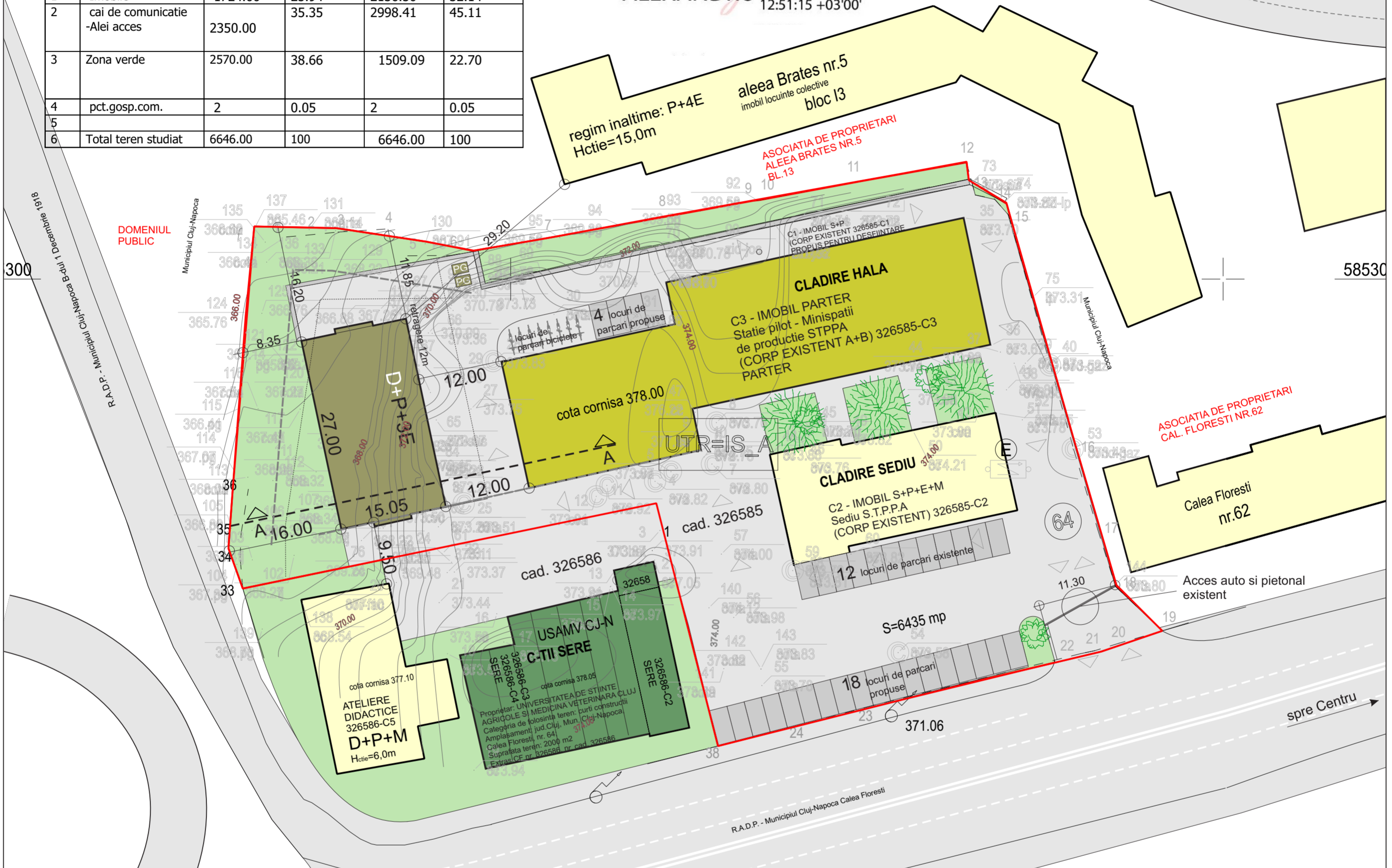

Indicatori parcelari:
IMOBIL PROPUȘ D+P+3E

Centru de transfer tehnologie "CTT - Biotech"
UTR-IS_A
P.O.T. max. = 60% ; C.U.T. max. = 2.2
REGIM TEHNIC
Suprafata teren conf. CF = 6646 mp
Suprafata construita existenta = 1724 m2
Suprafata desfasurata existenta = 3107m2
Suprafata construita propusa = 412.50m2
Suprafata desfasurata corp propus = 2101m2
Supra. construita totala-rezultata = 2136.50m2
Suprafata desfasurata totala finala = 5208m2

Regimul de inaltime propus: D+P+3
Nr. locuri de parcare asigurate in incinta = 34
S alei auto, pietonale propuse = 2998.41 m2
S spatiu verde propus = 1509.09 m2
P.O.T. existent = 25.94 %
C.U.T.existent = 0.47
P.O.T.propus = 32.14 % <60%
C.U.T.propus = 0.78 <2.2

CALCUL NECESAR DE PARCARI:
1 LOC PARCARE LA 80MP A.U. conf. PUG

PARCARI EXISTENTE:
12 PARCARI EXISTENTE

PARCARI PROPUȘE:
A.U. propus = 1296mp / 80mp = 16 PARCARI
+ 6 locuri suplimentare - total propuse 22 PARCARI

TOTAL NUMAR DE PARCARI: 34

Mihai Konradi
Digitally signed by Mihai Konradi
Date: 2020.06.22 11:12:39 +03'00'

Proprietar: UNIVERSITATEA DE ȘTIINȚE AGRICOLE ȘI MEDICINA VETERINARĂ CLUJ
Categoriza de folosinta teren: curti constructii
Amplasament: jud.Cluj, Mun. Cluj-Napoca, str. Calea Floresti, nr. 64;
Suprafata teren: 6646 m2
Extras CF nr. 326585, nr. cad. 326585

Proiectant general
BIROU DE PROIECTARE

sml
CONSTRUCT

S.C. SML CONSTRUCT S.R.L.
CUI: RO 19050468, J12/3172/2006
Sediul: Gilau, str.Braniste nr.113, jud.Cluj
office@smlconstruct.ro, 0740.092.110

ing. SALANTĂ MARIUS LUCIAN

Plan reglementari

stii proiect	SCARA	Denumirea proiectului: PUD CONSTRUIRE IMOBIL D+P+3E CU DESTINAȚIA CENTRU DE TRANSFER TEHNOLOGIC CTT-BIOTECH	NR. PR. 14/2020
SF PROIECT	1-500	Amplasament: calea Manastur nr 3-5, jud. Cluj	PUD
PROIECTAT		Beneficiar: UNIVERSITATEA DE ȘTIINȚE AGRICOLE ȘI MEDICINA VETERINARĂ CLUJ	
DESENAT		PLAN REGLEMENTARI	UP2

LEGENDA

- LIMITE**
- LIMITA TERENULUI STUDIAT
 - LIMITE DE PROPRIETATI
 - LIMITA DE PROPRIETATE PROPUSA AFERENT DEZMEMBRARE TEREN
- ALINIERE**
- ALINIERE
- ARIE TEREN PROPUS PENTRU DEZMEMBRARE**
- ARIE TEREN PROPUS PENTRU DEZMEMBRARE
- CONSTRUCTII**
- IMOBIL PROPUS
 - CONSTRUCTII EXISTENTE
- PROPRIETATI**
- TEREN PROPRIETATE PUBLICA DE INTERES PUBLIC
 - TEREN STUDIAT PROPRIETATE PRIVATA

Parcela (1)			
Nr. Pct.	Coordonate pct.de contur		Lungimi laturi D(i,i+1)
	X [m]	Y [m]	
38	585234.451	388929.106	14.392
24	585237.958	388943.064	12.469
23	585241.001	388955.156	17.578
22	585245.168	388972.233	10.978
21	585247.715	388982.911	9.029
19	585250.620	388991.460	9.088
18	585257.045	388985.033	21.006
16	585277.206	388979.134	34.856
14	585310.725	388969.574	6.139
13	585313.882	388964.309	2.614
12	585316.477	388963.998	9.053
11	585314.838	388955.095	34.147
8	585308.789	388921.488	15.135
6	585306.015	388906.609	2.926
5	585305.509	388903.727	9.156
4	585303.971	388894.701	6.693
3	585305.260	388888.133	12.676
2	585307.142	388875.597	11.589
1	585307.392	388864.011	12.597
20	585294.853	388862.806	17.640
36	585277.263	388861.482	15.105
34	585262.198	388860.387	5.987
33	585256.560	388862.400	59.263
37	585268.527	388920.442	35.160

S(1)=6646mp P=385.274m

BURA ALEXANDRU
Digitally signed by BURA ALEXANDRU
Date: 2020.06.03 12:51:15 +03'00'

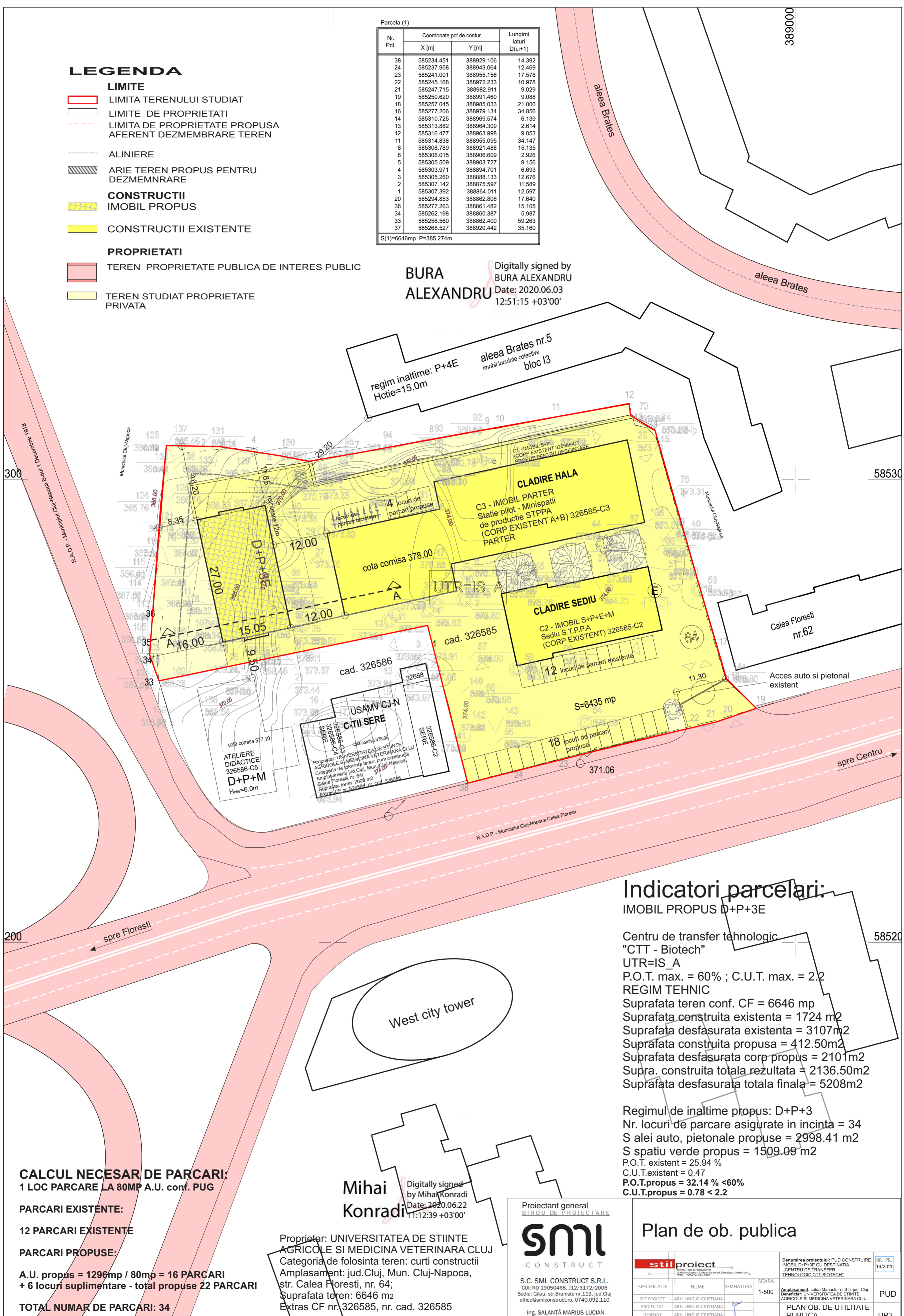

Indicatori parcelari:

IMOBIL PROPUS D+P+3E

Centru de transfer tehnologic "CTT - Biotech"
UTR=IS_A
P.O.T. max. = 60% ; C.U.T. max. = 2.2
REGIM TEHNIC
Suprafata teren conf. CF = 6646 mp
Suprafata construita existenta = 1724 m²
Suprafata desfasurata existenta = 3107 m²
Suprafata construita propusa = 412.50 m²
Suprafata desfasurata corp propus = 2101 m²
Supra. construita totala rezultata = 2136.50 m²
Suprafata desfasurata totala finala = 5208 m²

Regimul de inaltime propus: D+P+3
Nr. locuri de parcare asigurate in incinta = 34
S alei auto, pietonale propuse = 2998.41 m²
S spatiu verde propus = 1509.09 m²
P.O.T. existent = 25.94 %
C.U.T. existent = 0.47
P.O.T. propus = 32.14 % < 60%
C.U.T. propus = 0.78 < 2.2

CALCUL NECESAR DE PARCARI:

1 LOC PARCARE LA 80MP A.U. conf. PUG

PARCARI EXISTENTE:

12 PARCARI EXISTENTE

PARCARI PROPUSE:

A.U. propus = 1296mp / 80mp = 16 PARCARI
+ 6 locuri suplimentare - total propuse 22 PARCARI

TOTAL NUMAR DE PARCARI: 34

Mihai Konradi
Digitally signed by Mihai Konradi
Date: 2020.06.22 11:12:39 +03'00'

Proprietar: UNIVERSITATEA DE STIINTE AGRICOLE SI MEDICINA VETERINARA CLUJ
Categoriza de folosinta teren: curti constructii
Amplasament: jud. Cluj, Mun. Cluj-Napoca, str. Calea Floresti, nr. 64;
Suprafata teren: 6646 m²
Extras CF nr. 326585, nr. cad. 326585

Proiectant general
BIROU DE PROIECTARE

sml
CONSTRUCT

S.C. SML CONSTRUCT S.R.L.
CUI: RO 19050468, J12/3172/2006
Sediu: Gilau, str. Braniste nr. 113, jud. Cluj
office@smlconstruct.ro, 0740.092.110
ing. SALANTĂ MARIUS LUCIAN

Plan de ob. publica

SEF PROIECT	ARH. UNICUR CRISTIANA	SEMNAURA	SCARA	Denumirea proiectului: PUD CONSTRUIRE IMOBIL D+P+3E CU DESTINATIA CENTRU DE TRANSFER TEHNOLOGIC CTT-BIOTECH	NR. PR. 14/2020
PROIECTAT	ARH. UNICUR CRISTIANA		1-500	Amplasament: calea Manastur nr 3-5, jud. Cluj	PUD
DESENAT	ARH. UNICUR CRISTIANA			Beneficiar: UNIVERSITATEA DE STIINTE AGRICOLE SI MEDICINA VETERINARA CLUJ	UP3
				PLAN OB. DE UTILITATE PUBLICA	

Parcela (1)			
Nr. Pct.	Coordonate pct.de contur		Lungimi laturi D(i,i+1)
	X [m]	Y [m]	
38	585234.451	388929.106	14.392
24	585237.958	388943.064	12.469
23	585241.001	388955.156	17.578
22	585245.168	388972.233	10.978
21	585247.715	388982.911	9.029
19	585250.620	388991.460	9.088
18	585257.045	388985.033	21.006
16	585277.206	388979.134	34.856
14	585310.725	388969.574	6.139
13	585313.882	388964.309	2.614
12	585316.477	388963.998	9.053
11	585314.838	388955.095	34.147
8	585308.789	388921.488	15.135
6	585306.015	388906.609	2.926
5	585305.509	388903.727	9.156
4	585303.971	388894.701	6.693
3	585305.260	388888.133	12.676
2	585307.142	388875.597	11.589
1	585307.392	388864.011	12.597
20	585294.853	388862.806	17.640
36	585277.263	388861.482	15.105
34	585262.198	388860.387	5.987
33	585256.560	388862.400	59.263
37	585268.527	388920.442	35.160

S(1)=6646mp P=385.274m

BURA ALEXANDRU
 Digitally signed by BURA ALEXANDRU
 Date: 2020.06.03 12:51:15 +03'00'

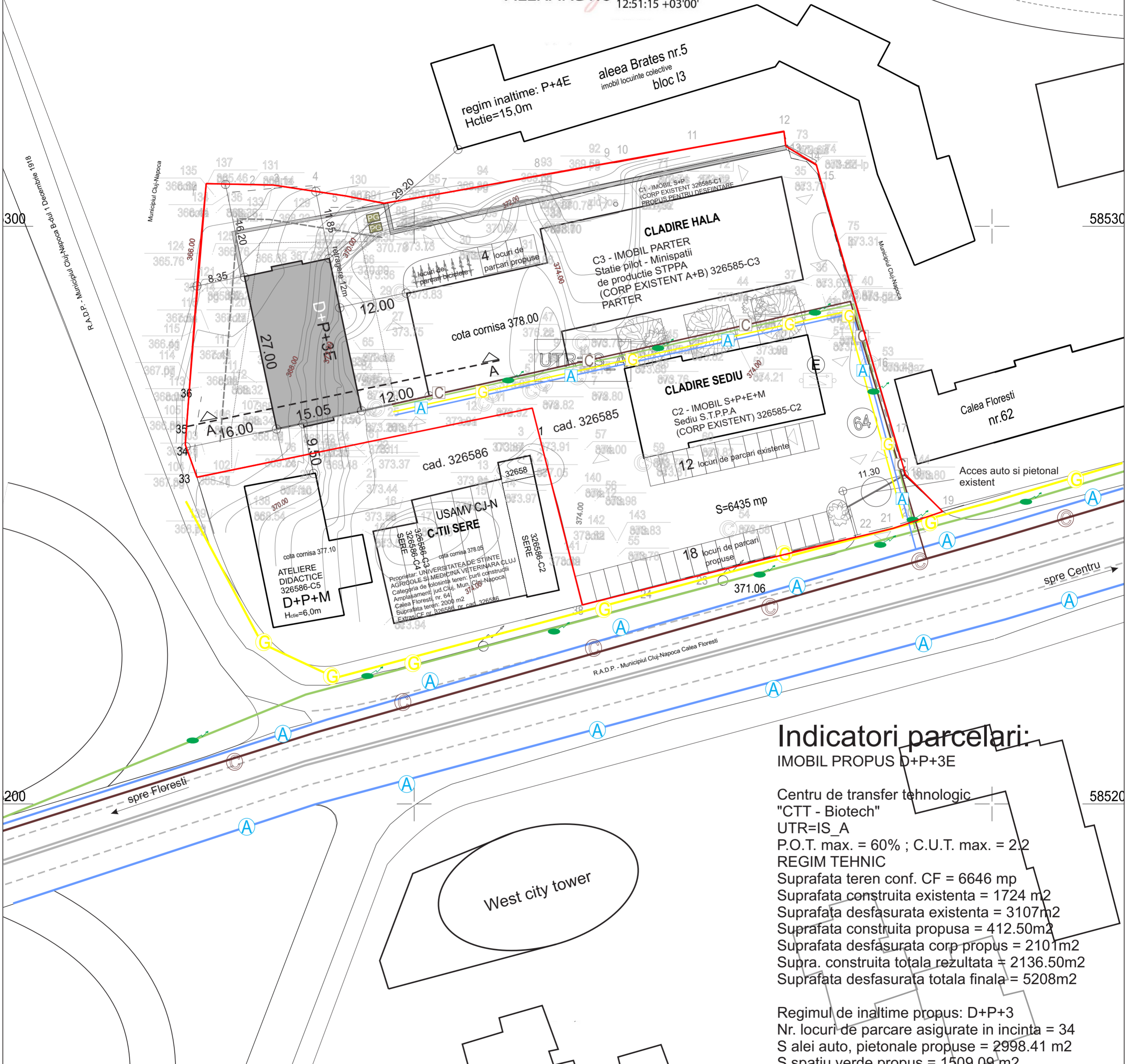

Indicatori parcelari:

IMOBIL PROPUȘ D+P+3E
 Centru de transfer tehnologic
 "CTT - Biotech"
 UTR=IS_A
 P.O.T. max. = 60% ; C.U.T. max. = 2.2
 REGIM TEHNIC
 Suprafata teren conf. CF = 6646 mp
 Suprafata construita existenta = 1724 m2
 Suprafata desfasurata existenta = 3107m2
 Suprafata construita propusa = 412.50m2
 Suprafata desfasurata corp propus = 2101m2
 Supra. construita totala rezultata = 2136.50m2
 Suprafata desfasurata totala finala = 5208m2
 Regimul de inaltime propus: D+P+3
 Nr. locuri de parcare asigurate in incinta = 34
 S alei auto, pietonale propuse = 2998.41 m2
 S spatiu verde propus = 1509.09 m2
 P.O.T. existent = 25.94 %
 C.U.T. existent = 0.47
 P.O.T. propus = 32.14 % <60%
 C.U.T. propus = 0.78 <2.2

CALCUL NECESAR DE PARCARI:
 1 LOC PARCARE LA 80MP A.U. conf. PUG
PARCARI EXISTENTE:
 12 PARCARI EXISTENTE
PARCARI PROPUȘ:
 A.U. propus = 1296mp / 80mp = 16 PARCARI
 + 6 locuri suplimentare - total propuse 22 PARCARI
TOTAL NUMAR DE PARCARI: 34

Mihai KONRADI
 Digitally signed by Mihai Konradi
 Date: 2020.06.22 11:12:39 +03'00'

Proprietar: UNIVERSITATEA DE ȘTIINȚE AGRICOLE ȘI MEDICINA VETERINARĂ CLUJ
 Categoria de folosință teren: curți construcții
 Amplasament: jud. Cluj, Mun. Cluj-Napoca, str. Calea Florești, nr. 64;
 Suprafata teren: 6646 m2
 Extras CF nr. 326585, nr. cad. 326585

Proiectant general
BIROU DE PROIECTARE
sml
 CONSTRUCT
 S.C. SML CONSTRUCT S.R.L.
 CUI: RO 19050468, J12/3172/2006
 Sediul: Gilau, str. Braniste nr.113, jud. Cluj
 office@smlconstruct.ro, 0740.092.110
 ing. SALANȚĂ MARIUS LUCIAN

Echipare edilitara

stil proiect			Denumirea proiectului: PUD CONSTRUIRE IMOBIL D+P+3E CU DESTINAȚIA CENTRU DE TRANSFER TEHNOLOGIC CTT-BIOTECH	NR. PR. 14/2020
SPECIFICATIE	NUME	SEMNAȚURA	SCARA 1-500	Amplasament: calea Mănăstir nr.3-5, jud. Cluj Beneficiar: UNIVERSITATEA DE ȘTIINȚE AGRICOLE ȘI MEDICINA VETERINARĂ CLUJ
SEF PROIECT	ARH. UNGUR CRISTIANA			PUD
PROIECTAT	ARH. UNGUR CRISTIANA			
DESENAȚ	ARH. UNGUR CRISTIANA			ECHIPARE EDILITARA UP4

Ilustrare urbanistica



Ilustrare urbanistica

