

BILANT TERITORIAL (parcela 1 S=1482.2mp)				BILANT TERITORIAL (parcela 3 S=332.6mp)					
UTR Et	EXISTENT		PROBUS		UTR Et	EXISTENT		PROBUS	
	mp	%	mp	%		mp	%	mp	%
1 S teren studiat	1482.2	100	1482.2	100.0	1 S teren studiat	332.6	100	332.6	100.0
2.1 S construita	0	0	526.6	35.5	2.1 S construita	0	0	0	0.0
2.2 S circulatii auto	0	0	345	23.3	2.2 S circulatii auto	0	0	271	81.5
2.3 S spatii verzi neamenajate	1482.2	100	0	0.0	2.3 S spatii verzi neamenajate	332.6	100	0	0.0
2.4 S spatii verzi amenajate	0	0	317.6	21.4	2.4 S spatii verzi amenajate	0	0	0	0.0
2.5 S circulatii pietonale	0	0	293	19.8	2.5 S circulatii pietonale	0	0	61.6	18.5
2.6 S construita desfasurata	0	0	526.6		2.6 S construita desfasurata	0	0	0	
3 POT	0	0	35.5		3 POT	0	0	0.0	
4 CUT	0	0	0.4		4 CUT	0	0	0.0	
5 Servitute publica	0	0	0		5 Servitute publica	0	0	0	
6 Regim inaltime	P				6 Regim inaltime	-	-	-	
7 H maxim	0	0	12m		7 H maxim	0	0	0	
8 nr. parcari	0	0	10		8 nr. parcari	0	0	0	

BILANT TERITORIAL (parcela 2 S=1397.4mp)				BILANT TERITORIAL (parcela 4 S=387.8mp)					
UTR Et	EXISTENT		PROBUS		UTR Et	EXISTENT		PROBUS	
	mp	%	mp	%		mp	%	mp	%
1 S teren studiat	1397.4	100	1397.4	100.0	1 S teren studiat	387.8	100	387.8	100.0
2.1 S construita	0	0	519.4	37.2	2.1 S construita	0	0	0	0.0
2.2 S circulatii auto	0	0	368	26.3	2.2 S circulatii auto	0	0	387.8	100.0
2.3 S spatii verzi neamenajate	1397.4	100	0	0.0	2.3 S spatii verzi neamenajate	387.8	100	0	0.0
2.4 S spatii verzi amenajate	0	0	333	23.8	2.4 S spatii verzi amenajate	0	0	0	0.0
2.5 S circulatii pietonale	0	0	177	12.7	2.5 S circulatii pietonale	0	0	0	0.0
2.6 S construita desfasurata	0	0	3353.76		2.6 S construita desfasurata	0	0	0	
3 POT	0	0	37.2		3 POT	0	0	0.0	
4 CUT	0	0	2.4		4 CUT	0	0	0	
5 Servitute publica	0	0	0		5 Servitute publica	0	0	387.8	
6 Regim inaltime	-	-	(1-3)S+P+5E+R		6 Regim inaltime	-	-	-	
7 H maxim	0	0	25		7 H maxim	0	0	0	
8 nr. parcari	0	0	8		8 nr. parcari	0	0	0	

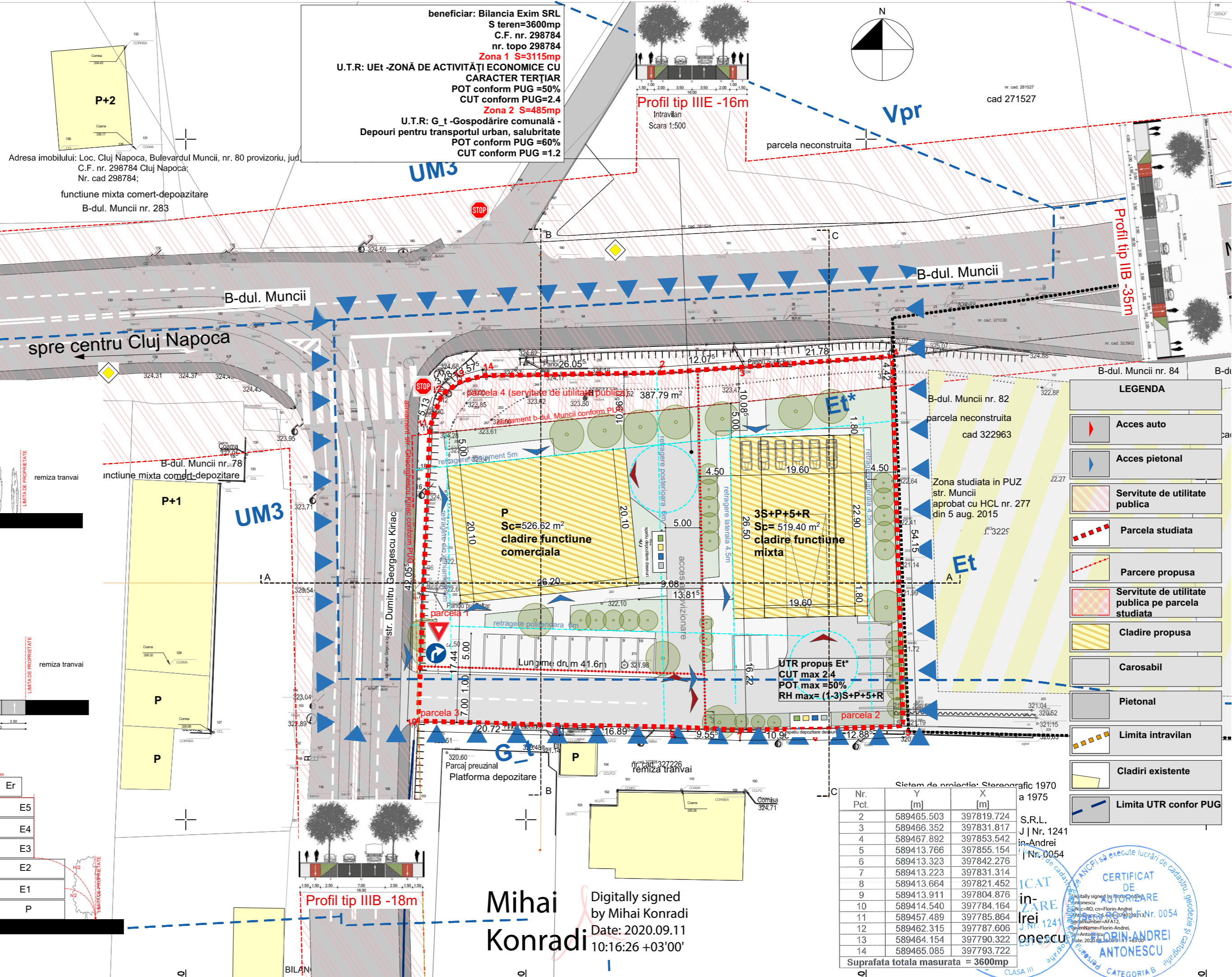

sectiunea C-C

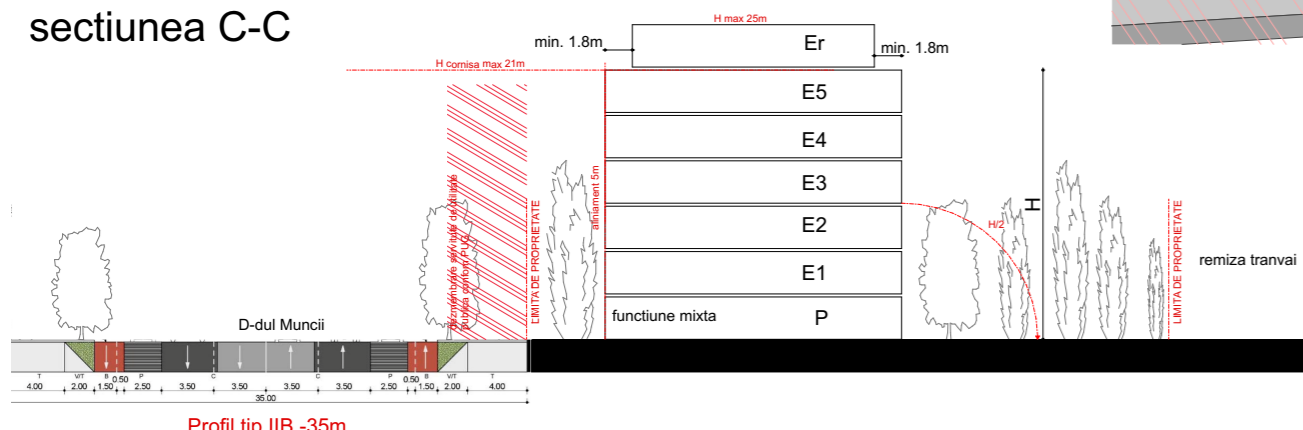

Profil tip IIB -35m

sectiunea B-B

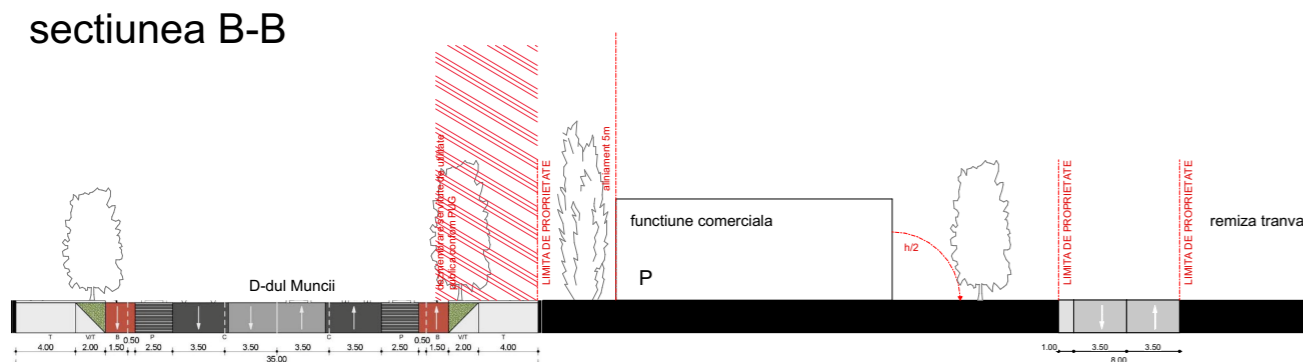

Profil tip IIB -35m

sectiunea A-A

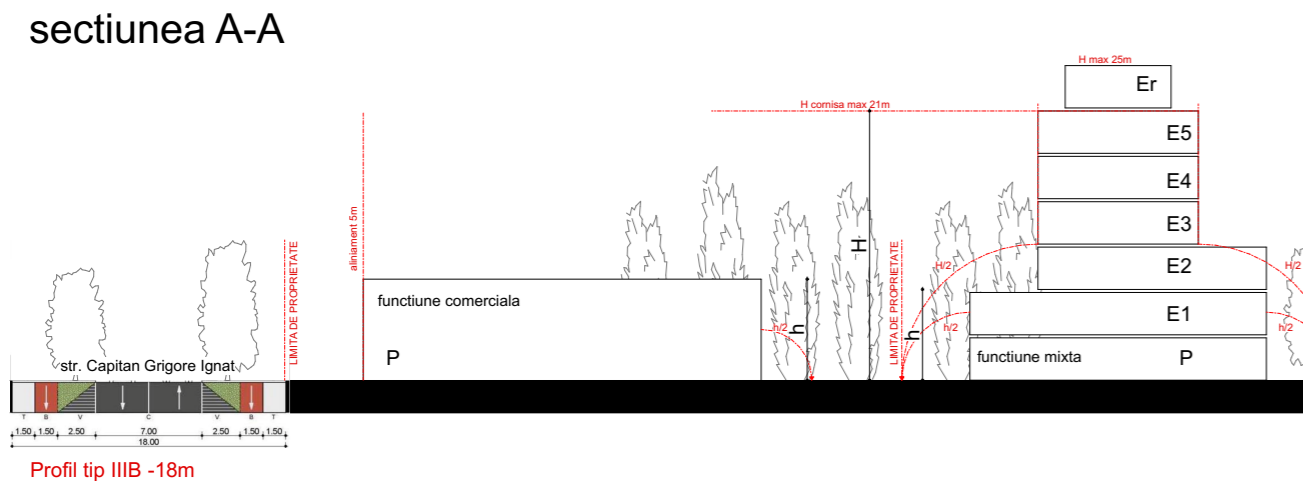

Profil tip IIIB -18m

LEGENDA	
	Acces auto
	Acces pietonal
	Servitute de utilitate publica
	Parcela studziata
	Parcere propusa
	Servitute de utilitate publica pe parcela studziata
	Cladire propusa
	Carosabil
	Pietonal
	Limita intravilan
	Cladiri existente
	Limita UTR confor PUG

Sistem de proiectare: Stereografic 1970 a 1975

Nr. Pct.	Y [m]	X [m]
2	589465.503	397819.724
3	589466.352	397831.817
4	589467.892	397853.542
5	589413.766	397855.154
6	589413.323	397842.276
7	589413.223	397831.314
8	589413.664	397821.452
9	589413.911	397804.876
10	589414.540	397784.164
11	589457.489	397785.864
12	589462.315	397787.606
13	589464.154	397790.322
14	589465.085	397793.722

Suprafata totala masurata = 3600mp

ARHIMAR
ARHITECTURA / URBANISM

BIROU DE ARHITECTURA
Str. Calarasilor, nr. 1, Pavilion H, Cluj-Napoca, Romania
T: +40 264 596786, F: +40 264 592614
www.arhimar.ro

Echipe de proiectare

arh. Adrian Bedreaga

arh. Matei Farte

Verificat

arh. Valentin Moldovan

Sef Proiect

arh. Claudiu Botea

PUZ de urbanizare si parcelare, construire ansamblu mixt, B-dul Muncii cu str. Dumitru Georgescu Chiriac

Beneficiar

Bilancia Exim SRL
sat Petresti, Com. Corbeanca, str. Balantei nr. 46 (C1), jud. Ilfov

Adresa investitiei

B-dul Muncii, nr.80, Cluj Napoca, Jud.Cluj

Proiect

Proiect nr. 1373/2019

Faza P.U.Z.

Scara 1:50

Data 3/9/2021

ARH-03"

Plan mobilare urbanistica

CATEGORIA DE IMPORTANTA "C"

ZONA SEISMICA "F"

CLASA DE IMPORTANTA "III"

GRADUL DE REZISTENTA LA FOC IV

Acest desen si informatiile cuprinse in el nu pot fi copiate, reproduse sau utilizate, partial sau in intregime decat cu acordul scris al ARHIMAR si nu pot fi folosite in alt scop decat cel pentru care au fost elaborate. Aceasta plansa reprezinta extras din Proiectul Tehnic, necesara pentru autorizare si nu va fi folosita pentru executie

Mihai Konradi
Digitally signed by Mihai Konradi
Date: 2020.09.11 10:16:26 +03'00'

