

KOGALNICEANU CLUJ-NAPOCA DESIGN COMPETITION



None any other history: street possessing such a great accumulation of values that are related exclusively to the cultural and spiritual realm, without any intrusion by the world of other architectural elements.

Symbols, spatial focus, crystallized cultural and educational order, significant spatially bordered by a dignified built heritage. It is able to a noble sense, added to street to the depth by the simple yet appropriately shaped and stone glass, masonry and a simple respectful support towards the engaged values of the standing in time substance of light. It is as though evidence has already taken its course and development is not what is called for today, but rather a return to its basic principles and towards suitable habitation.

The case of square paving, college situation, churches, libraries, palaces, through spatial and functional relationships, strongly evokes the game of regression. The strongly symbolic and material "game" pursued in the middle ages by clerics in the structures of cathedrals, has been preserved in the world of civil gardens. It is the ritual of an everyday lives which we are bound to exact, tailored to our own fortunes and capabilities, hopping and bounding from the main square and back, embracing as well helping us grow along the way.

The winning team in this respect belongs to King Matthias Corvinus, who lays down the basic square of the game today's reinforced structure.

In conclusion, after the 18th century city wall breaks off the outward heading street, the street closed off street later phase. In eastern and ending, which to remain the most remote almost part of the inner fortified city. Historically blocking off but at the same time also enveloping the street, Eastern Europe's largest hall church was built, which during the opening half millennium served effectively space its surroundings right through to the main square forming the spiritual focal of the entire region. PLATON LUPOMAN

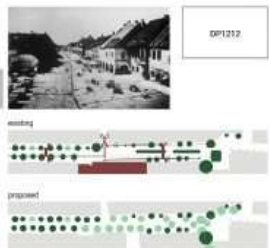
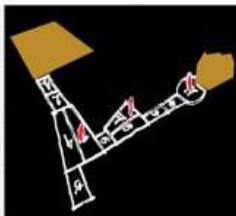

01/202

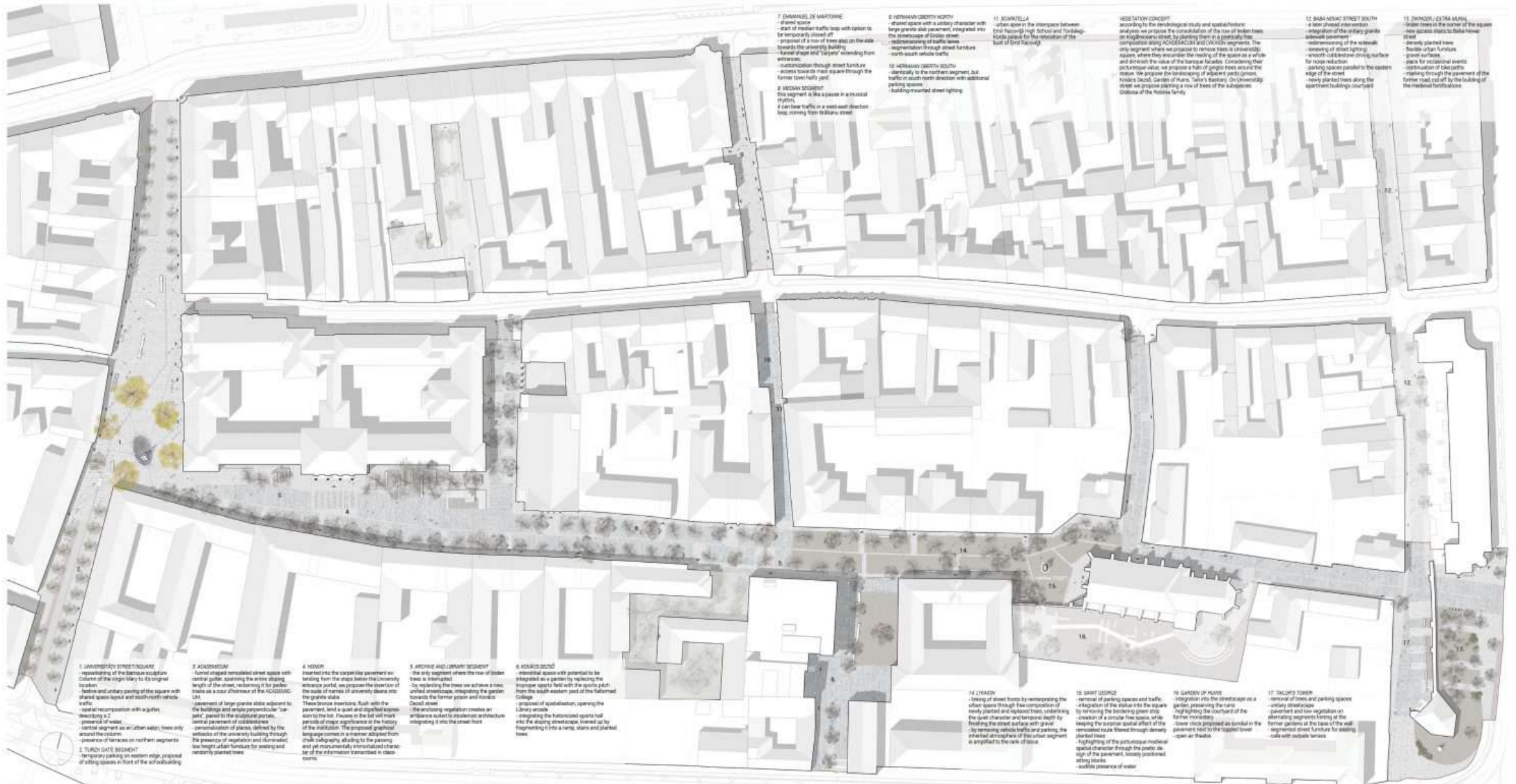

- 7. CHAMARTEL DE MARITIMONE**

 - shared space
 - start of median traffic loop with option to be temporarily closed off
 - proposal of a row of trees and on the side towards the university building
 - "funnel square" and "jet" extending from entrance
 - continuation through street furniture
 - access toward main square through the former town hall yard
- 8. MEDIAN CHAIRS**

 - this segment is the space in a crucial point
 - a car lane traffic in a west-east direction loop, coming from Triliana street
- 9. HETMANIA CHURCH NORTH**

 - shared space with urban character with large granite and pavement, integrated into the street space of the street
 - modernization of traffic lanes
 - segmentation through street furniture
 - north-south vehicle traffic
- 10. HETMANIA CHURCH SOUTH**

 - identical to the northern segment but traffic in south-north direction with additional parking spaces
 - building-mounted street lighting
- 11. BOMBEJELA**

 - urban space in the interspace between East Hetman High School and Triliana
 - Kocika park for the restoration of the last of Erdel family
- VEGETATION CONCEPT**

 - according to the dendrological study and cost-effective analysis we propose the consolidation of the row of beech trees on Kogalniceanu street, by planting them in a partially free composition along JACOBIUS and UKACHIN segments. The only segment where we propose to remove trees is Universitat square, where they encounter the meeting of the square as a full and diminish the value of the baroque facade. Considering that decorative value, we propose a row of apple trees around the square. We propose the landscaping of adjacent streets (Triliana, Kovacs DEZSO, Garden of Huro, Taler's Bastion, On University street, we propose planting a row of trees of the subgenus: DISODIA of the Feltre family.
- 12. BASSA MINAC STREET SOUTH**

 - a later ground intervention
 - integration of the urban granite
 - sidewalk pavement
 - modernization of the sidewalk
 - opening of street lighting
 - smooth sidewalk paving surface
 - for noise reduction
 - parking spaces parallel to the eastern edge of the street
 - new planted trees along the apartment buildings courtyard
- 13. ZIMBRII / EXTRA MURAI**

 - urban trees in the corner of the square
 - new access stairs to Boka-Kocika street
 - densely planted trees
 - flexible urban furniture
 - ground furniture
 - place for occasional events
 - continuation of the paths
 - meeting through the pavement of the former road, cut off by the building of the residential furniture
- 1. UNIVERSITY STREET SQUARE**

 - reorganization of the baroque structure
 - column of the large library to its original location
 - flexible and unitary paving of the square with shared space layout and south-western vehicle traffic
 - spatial reorganization with a garden
- 2. ACADEMISM**

 - formal shaped remodelled street space with central garden, spanning the entire sloping length of the street, retaining its grid pattern as a core structure of the ACADEMISM
 - placement of large granite slabs adjacent to the buildings and origin perpendicular "canal", paved in the residential pattern
 - central pavement of cobblestones
 - permeabilization of slabs, defined by the setbacks of the university building through the placement of vegetation and illuminated low height urban furniture for seating and centrally planted trees
- 4. HENRI**

 - located into the canal-like pavement extending from the steps below the Community entrance portal, we propose the insertion of the scale of narrow of arched slabs into the granite slabs
 - These bronze interventions, flush with the pavement, lend a quiet and dignified expression to the lot. Devices in the lot will mark periods of major significance in the history of the institution. The personal graphical language comes in a manner adapted from clock technology, adding to the paving and yet monumentally monumental character of the information transmitted in classrooms.
- 5. ARCHIVE AND LIBRARY SEGMENT**

 - the only segment where the row of beech trees is interrupted
 - by replacing the trees we achieve a more unified streetscape, integrating the garden towards the former park and Kovacs DEZSO street
 - the existing vegetation creates an ambience suited to modernist architecture integrating it into the street flow
- 6. KOVACS DEZSO**

 - residential space with potential to be integrated as a garden by replacing the structure of the hall with the sports path from the south-eastern part of the former College
 - proposal of spatialization, opening the Library arch
 - integrating the historicized sports hall into the existing streetscape, lined up by fragmenting it into a ramp, stairs and planted trees
- 14. TRILIANA**

 - linking of street forms by reorganizing the urban space through free composition of newly planted and re-planted trees, underlining the quiet character and temporal depth by finishing the street surface with gravel
 - by removing vehicle traffic and parking, the street, although part of the street segment is applied to the rank of a park
- 15. SARTY GEORGE**

 - removal of parking spaces and traffic
 - integration of the stairs into the square by marking the bordering green strip
 - creation of a circular free space, which keeping the surprise spatial effect of the residential scale, flows through the densely planted trees
 - The lighting of the porch space makes a special character through the specific design of the pavement, locally positioned sitting stools
 - subtle presence of water
- 16. GARDEN OF PEACE**

 - integration into the structure as a garden, preserving the square
 - highlighting the courtyard of the former monastery
 - lower clock proposed as symbol on the pavement laid to the right of the tower - open as a shade
- 17. TALLON'S TOWER**

 - removal of trees and parking spaces
 - urban intervention
 - pavement and low vegetation on alternating segments facing at the former gardens at the base of the wall
 - segmented street furniture for seating
 - side with outside terrace

KOGALNICEANU CLUJ-NAPOCA DESIGN COMPETITION

10. BLOCUL JAVOSI SOUTH
 remodeling and paving with unitary large granite slabs.
 Pedestrian only, single pavement sections installed through reconstruction geometrically invented by Balazs Javosi.
 gutters hidden into the pavement, medium height urban lights

10. BLOCUL JAVOSI NORTH
 remodeling and paving with unitary large granite slabs.
 shared space with relocated traffic lane, bollards, redimensional and segmented through as set furniture



LIGHTING
 preserving the atmosphere of the street, the spatial character as well as the archaeological requirements on the lighting of pedestrian zones, we primarily propose lighting fixtures of medium height and medium light intensity and a wide beam angle, a light color of 3000K, and contrasting them with higher, multi-beam lighting fixtures with a soft general spectrum of 4000K. Central recessed in-pavement lighting is proposed only on University square, the tower of the modernist Casa Universitarilor, the Reformed Church and the Taler's Bastion, following multi-testing.



SEC 1 - FESTIVAL ON THE STREET
 - Entertainment
 - Food & Drink
 - Music

SEC 2 - EVENTS IN THE PARK YARDS
 - Entertainment
 - Food & Drink
 - Music

SEC 3 - MOODS EVENTS AND LIGHTING MASTERPLAN

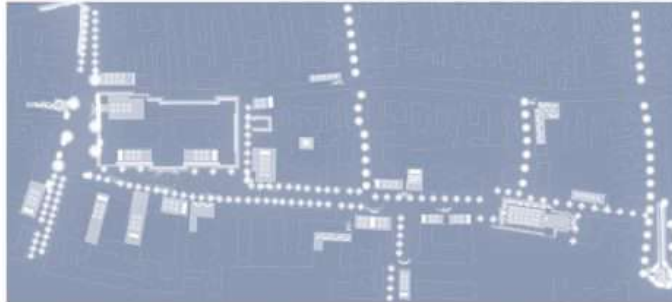

UNIVERSITY STREET
 Our proposal aims to highlight the monumentality and urban scale, extending from Main Square, through making it a shared space with a uniform, social atmosphere. Large scale granite slabs laid out without joints, with the western edge of Main Square and a rearrangement of vegetation, resulting in a light spatial segmentation.

1. Centralized - Geometric Palace / Arts Center, by leaving a double row of axons (double-proposed trees, the historic layout) with a central lane kept open to preserve the views towards Convictia Hall and the Virgin Mary monument.

2. University square, brought into focus by the monument of the Virgin Mary returned to its original spot, with new shaped fountains pointing towards the surrounding historic portals. Around the statue an slight, concave sloping of the pavement underlines the spatial and stylistic resonance formed between these. 8 fountains form the starting points of these markers, projecting an aura of gentle trees surrounding the monument in a broader scope that is historically usual. All these define the ambience of individual and context (libraries, open, fine social).

3. The proposed a modeling of the streetscape by a central, funnel shaped gutter accentuating the axial Church through its reflection.

The role established by whitening both Universitarii and Kogalniceanu streets with simple, unadorned custom-made street lighting adapted to pedestrian spaces with built trees, makes any for an exception on University square by adopting the lighting logic of Main Square.

3. The connecting segment towards former Taler's gate, will view through the double axons (double-proposed trees, forming both portals representing the extremities of the street).

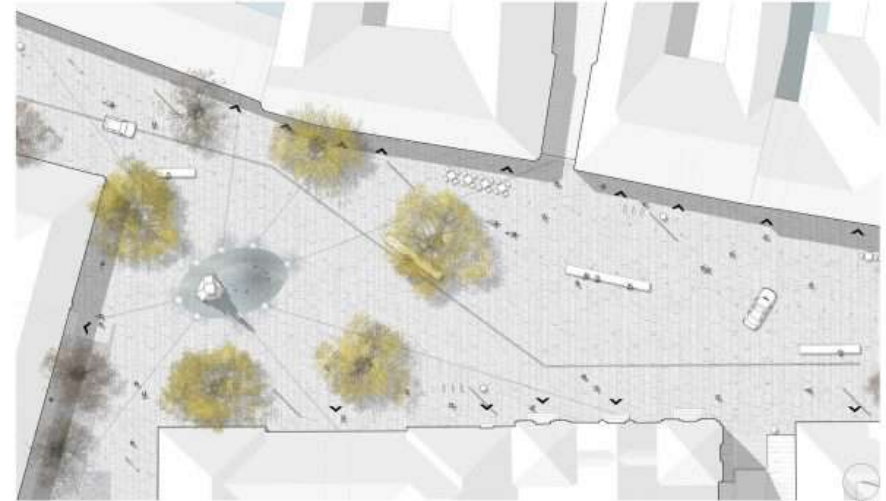

Due to the city being an extension area of existing built-up areas, the design of the competition is based on the existing urban fabric. The design is not intended to be a complete urban regeneration project. The design is based on the existing urban fabric and the design is not intended to be a complete urban regeneration project. The design is based on the existing urban fabric and the design is not intended to be a complete urban regeneration project.

KOGALNICEANU CLUJ-NAPOCA DESIGN COMPETITION

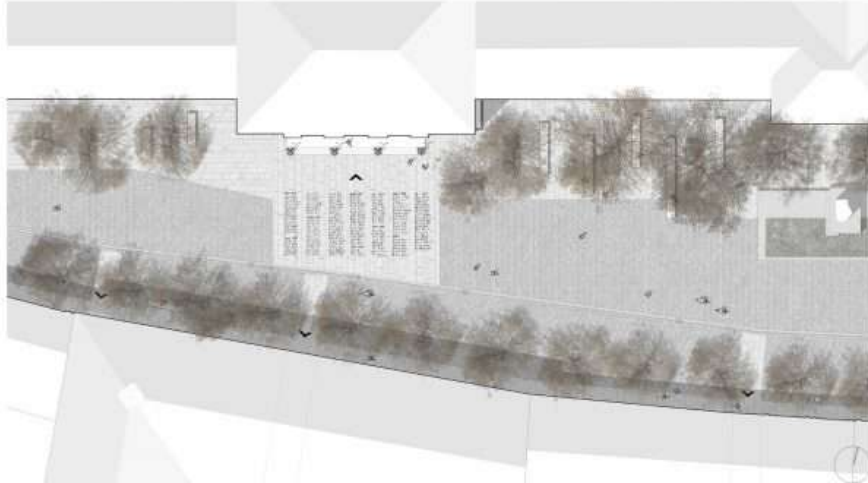

ACADAMIA
The beginning of Kogalniceanu street bears the element of surprise right from its historical beginnings through the section between its north and south sides (the latter of which for a long time stood free of buildings along the outer city wall). On the segment we can observe the arched compactness and coherence of the southern front in tense dialogue with the opposite side defined by the monumental volume of the University. These form a total urban logic like an emblematic of the surrounding educational institutions. The subtle contrasting and thus more distanced presence of the modernist tower is available, contrasting the spatial composition.

We propose the removal of vehicles from this segment of the street and a strengthening of the dialogue between the two fronts, along the lines of their given spatial qualities. The order born by the university further accentuates this relationship, distilling the sober and strict character of classrooms towards the urban space like a garden. The reduction of the pavement without separate sidewalks and road surface and the adoption of the formal slope with a central gutter are the main integrating elements subtly reinforcing the historic atmosphere. The delicate intervention on the iron hand components the lightly ascending, view towards the facade, strengthening their presence, while on the other hand, through its highly reflecting course has a distilling effect, enhancing the rich historic atmosphere of the space. We take note of the sculptural shapes, widely rhythm and missing presence of the entrance porches and stairs. The proposal is active, through large granite slabs and light with the pavement, interpreted as capitals referring to the central gutter without representing overly patterned design elements.

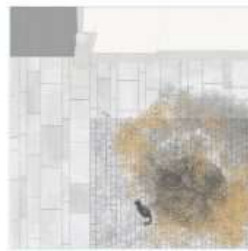

MOVEMENT PATTERNS AND MATERIAL COLLECTION

We propose pavement materials made of natural stone, comprising cobblestones and large granite slabs. The latter are placed free position traffic, comprising the design of main square. The influence of the newly restored spaces being awarded to the most valuable objectives, highlighted by the presence of the hospital. The central gutter is also made of the same material of cobblestones (approximately 40x15x500mm), the same as the capitals in front of the porches that segment the facade, defining the surface paved with "flexible" hand arches. We propose the joints of the pavement to be filled with small round stone chipmoss of the same rock.

The materials chosen are treated two coats impregnation of the surface they touch. The gratings, drainage channels and venting covers, as well as the tree poles are metallic, come in granite with their joints filled with the same stone chipmoss as the pavement.



0P1212

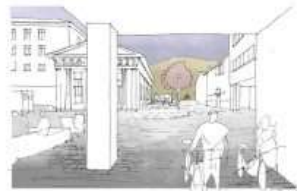

LENIN
The richness and ambience arising from the depth of historic layers gathered here represents the centerpiece of the area. Lenin is the name of Socrates' favorite place in Athens, where he set up the first middle school, from which the term "junior" originates. Throughout the fortified inner city of Cluj a densely populated urban fabric can be observed resulting in streets lined with completely built up facades. The corner of the city around the reformed church represents an exception bearing a lighter urban fabric: as until 1862 it was a cul-de-sac with several houses built up. The central role over having a direct line towards the gate at the end of Colivel street, the corner the portal of the church together with the aqueduct and the surrounding school buildings (formed over half a century) to be the backdrop as well as the height of the street, without varying the code that later finishes the made to the "Lenin" Tower. Owing to the three garbled levels in the segment of the street, the lower ones being the facade as set down to the building, breaking the line established by the trees as the middle segment of the view. The call for the reduction of traffic on this segment of the street limiting it only to authorized and local residents onto the central sides are essential and for the strengthening of the urban fabric including a apartment to be done in a manner as to create a lighter, less compressed atmosphere better suited to the historic air of the surroundings, actively setting up a surprising spatial experience as leaving the trees nearby the St. George station. The goal is to create a setting suited to experiencing gothic architecture, where the architectural object presents a surprise in the closed, modest and smaller scale items of its surroundings. The facade of the church with its monumental gable leads to significant presence throughout the entire length of the street perspective of the presence of the existing log frame. Keeping from the large granite slab pavements which line the facade of the buildings as well as the continuity of the central gutter with its reflectance, the large open surfaces in this part of the street will have a good finish to between the wearing made of stone blocks creating a stone mosaic working (backside) a fountain forming a reflector, with its water slowly overflowing. It is a discrete public presence, symbolic of a laboratory, non-assert of the idea of public Transylvanian preservation which right from its early years played a key role in shaping the whole region.

